



INTERACTIVE
DISPLAYS
IRELAND

PCAP Touch Kiosk Screen

Available Sizes

43", 50", 55"



Overview

This all-in-one interactive display combines the best in PCAP Touch Screen technology with a stylish and secure kiosk. The screen resembles a giant tablet with the edge to edge glass tempered front and aluminium bezel. Designed for use in commercial applications the easy to use ergonomic design allows users to interact with the screen perfectly.

Key Features



24/7 Commercial Use



PCAP Touch Screen



L.E.D Backlight



Eco Power-Timer

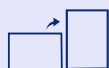

Adaptable Orientation



Dual Operating Systems



3 Years
Warranty



IRISH
OWNED



Tablet-Like Styling

Designed to resemble a giant smartphone or tablet. The sleek look is achieved with a striking aluminium surround and stunning IPX1 rated edgeto-edge glass..



Anti Fingerprint Glass

Thanks to a special plasma treatment the tempered glass front is more resistant to oil / water residue left by fingerprint marks. Unlike other Touch Screens the glass is not etched, vastly improving the optical clarity.



IPS Panel

With 450cd/m2 the IPS panel shines brighter than any domestic television while delivering superior image quality and colour depth at 178° ultra wide viewing angle in all directions.



Dual OS

Both Android and Windows operating systems installed on the integrated PC it cannot be beaten on flexibility. Easily switch from your Windows desktop to the Android apps.

Interactive Displays Ireland

 Dromone, Oldcastle, Co. Meath, Ireland

 0449672855  www.interactivedisplays.ie

Internal Locker



The kiosk has a discrete internal locker at the rear of the stand. A small form factor PC or media player can be installed here then connected to the screen and rear ports for a convenient all-in-one solution.



10 Point Touch

Using the most responsive and sensitive commercial touch technology available. Not affected by dust or debris on the screen surface.



Smooth Touch Gestures

Perform smoother touch gestures with our specially treated glass which lowers the surface tension and friction of the touch surface. It is also more scratch resistant and durable than ever, making it ideal for commercial use.



USB Ports

Attach third party peripherals to the internal PC via the USB ports inside the internal locker or the rear inputs.



- 1 High quality tempered glass protection
- 2 High resolution, high contrast, high brightness, great improvement of the picture level, and better performance of details
- 3 Using the professional LCD screen, the video image is brighter and the three-dimensional sense is stronger
- 4 16.7M color, the picture is more natural, the delicate picture is really not tailed
- 5 Ultra long life, 7*24 hours uninterrupted work, up to more than 60 thousand hours

Strong digital audio power amplifier, high fidelity audio decoding, strong 2x 5W high fidelity sound box horn, perfect restore multimedia sound

Rich interface: support SD card
USB2.0 hard disk, U disk

Strong sheet metal housing

Security and anti-theft design

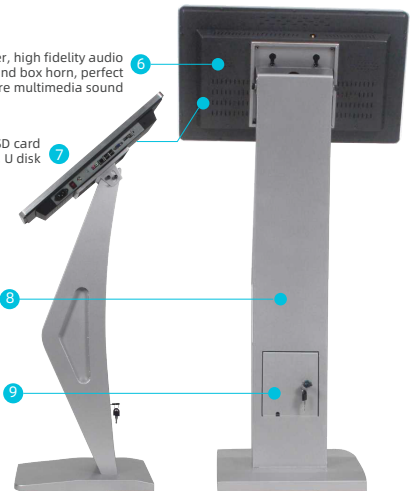

Application

Hospitality



Retail



Commercial

Specifications

43"

50"

55"

Model: TAO43E3

Display Area: 942.5×530.5

Unit Size: 1048.9×1246×534.25

Package Size: Box 1: 1003×678×435 Box 2: 1180×772×230

Net Weight: 66.55kg

Gross Weight: 77.25kg

Power Consumption: 65watts

43"

50"

55"

Model: TAO50E3

Display Area: 1076×606

Unit Size: 1186×1285×599.4

Package Size: Box 1: 1003×678×435 Box 2: 1350×865×260

Net Weight: 73.05kg

Gross Weight: 85.50kg

Power Consumption: 75watts

43"

50"

55"

Model: TAO55E3

Display Area: 1211×682

Unit Size: 1319.6×1320×660.2

Package Size: Box 1: 1003×678×435 Box 2: 1480×950×250

Net Weight: 81.60kg

Gross Weight: 95.60kg

Power Consumption: 85watts

Specifications

Panel:

Resolution: 1920×1080

Aspect Ratio: 16:9

Brightness (CD/M2): 450

Colour: 16.7M

Viewing Angle: 178°

Contrast Ratio: 5000:1

Footprint: 800×500

Environmental:

Operating Temperature: 0°C to 50°C

Storage Temperature: -30°C to 60°C

Operating Humidity: 10% to 80%

Storage Humidity: 5% to 95%

Computer:

CPU: Intel® Atom™ (Quad-core) x5-Z8350

Processor (2M Cache, up to 1.92 GHz)

RAM: 4GB (DDR3L-RS 1600MHz)

Instruction set: 64-bit

Graphic Engine: Intel® HD Graphics 400 (8th Gen, Supports DirectX11.2, OpenGL4.4 and OpenCL 2.0)

Internal Memory: 64GB

USB: 2 x USB 2.0

LAN: 10/100/1000M Ethernet

Wi-Fi: 802.11b/g/n

OS: Android /Windows

AV Inputs:

Video: HDMI, VGA, BNC

Control: RS-232

Audio: Audio Socket (3.5mm)

Speaker Type: 2W, 5Ω (x2)

Input Voltage: AC110~240V (50Hz~60Hz)

Media Player:

Video: MPG, AVI, MP4, RM, RMVB, TS

Audio: MP3, WMA

Image: JPG, GIF, BMP, PNG

Touch:

Touch Technology: Projected Capacitive

Touch Points: 10

Glass hardness: 7H minimum

Accessories:

Included: Remote Control, User Manual, Power Cable, USB to USB Cable, Wi-Fi Aerial

Optional: Special Wall Mount, Floor Stand/Trolley, Ceiling Mount, Table Stand