



INTERACTIVE  
DISPLAYS  
IRELAND

# PCAP Touch Kiosk Screen

Available Sizes

43", 50", 55"



## Overview

This all-in-one interactive display combines the best in PCAP Touch Screen technology with a stylish and secure kiosk. The screen resembles a giant tablet with the edge to edge glass tempered front and aluminium bezel. Designed for use in commercial applications the easy to use ergonomic design allows users to interact with the screen perfectly.

## Key Features



**24/7 Commercial Use**



**PCAP Touch Screen**



**L.E.D Backlight**



**Eco Power-Timer**

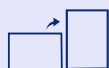

**Adaptable Orientation**



**Android Operating System**



3 Years  
Warranty



IRISH  
OWNED



### Tablet-Like Styling

Designed to resemble a giant smartphone or tablet. The sleek look is achieved with a striking aluminium surround and stunning IPX1 rated edgeto-edge glass..



### Anti Fingerprint Glass

Thanks to a special plasma treatment the tempered glass front is more resistant to oil / water residue left by fingerprint marks. Unlike other Touch Screens the glass is not etched, vastly improving the optical clarity.



### IPS Panel

With 450cd/m2 the IPS panel shines brighter than any domestic television while delivering superior image quality and colour depth at 178° ultra wide viewing angle in all directions.



### Android OS

Android operating systems installed on the integrated PC it cannot be beaten on flexibility. Option HDMI-In for windows available at additional cost.

## Interactive Displays Ireland

 Dromone, Oldcastle, Co. Meath, Ireland

 0449672855  [www.interactivedisplays.ie](http://www.interactivedisplays.ie)

## Internal Locker



The kiosk has a discrete internal locker at the rear of the stand. A small form factor PC or media player can be installed here then connected to the screen and rear ports for a convenient all-in-one solution.



## 10 Point Touch

Using the most responsive and sensitive commercial touch technology available. Not affected by dust or debris on the screen surface.



## Smooth Touch Gestures

Perform smoother touch gestures with our specially treated glass which lowers the surface tension and friction of the touch surface. It is also more scratch resistant and durable than ever, making it ideal for commercial use.



## USB Ports

Attach third party peripherals to the internal PC via the USB ports inside the internal locker or the rear inputs.



- 1 High quality tempered glass protection
- 2 High resolution, high contrast, high brightness, great improvement of the picture level, and better performance of details
- 3 Using the professional LCD screen, the video image is brighter and the three-dimensional sense is stronger
- 4 16.7M color, the picture is more natural, the delicate picture is really not tailed
- 5 Ultra long life, 7\*24 hours uninterrupted work, up to more than 60 thousand hours

Strong digital audio power amplifier, high fidelity audio decoding, strong 2x 5W high fidelity sound box horn, perfect restore multimedia sound

Rich interface: support SD card  
USB2.0 hard disk, U disk

Strong sheet metal housing

Security and anti-theft design

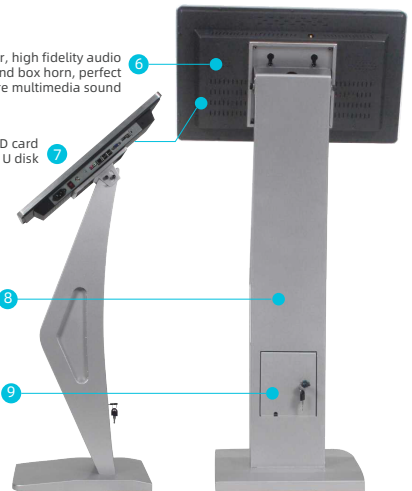

# Application

## Hospitality



## Retail



## Commercial

# Specifications

43"

50"

55"

**Model:** TAO43E3

**Display Area:** 942.5×530.5

**Unit Size:** 1048.9×1246×534.25

**Package Size:** Box 1: 1003×678×435 Box 2: 1180×772×230

**Net Weight:** 66.55kg

**Gross Weight:** 77.25kg

**Power Consumption:** 65watts

43"

50"

55"

**Model:** TAO50E3

**Display Area:** 1076×606

**Unit Size:** 1186×1285×599.4

**Package Size:** Box 1: 1003×678×435 Box 2: 1350×865×260

**Net Weight:** 73.05kg

**Gross Weight:** 85.50kg

**Power Consumption:** 75watts

43"

50"

55"

**Model:** TAO55E3

**Display Area:** 1211×682

**Unit Size:** 1319.6×1320×660.2

**Package Size:** Box 1: 1003×678×435 Box 2: 1480×950×250

**Net Weight:** 81.60kg

**Gross Weight:** 95.60kg

**Power Consumption:** 85watts

# Specifications

## Panel:

**Resolution:** 1920×1080

**Aspect Ratio:** 16:9

**Brightness (CD/M2):** 450

**Colour:** 16.7M

**Viewing Angle:** 178°

**Contrast Ratio:** 5000:1

**Footprint:** 800×500

## Environmental:

**Operating Temperature:** 0°C to 50°C

**Storage Temperature:** -30°C to 60°C

**Operating Humidity:** 10% to 80%

**Storage Humidity:** 5% to 95%

## Computer:

**CPU:** Intel® Atom™ (Quad-core) x5-Z8350

Processor (2M Cache, up to 1.92 GHz)

**RAM:** 4GB (DDR3L-RS 1600MHz)

**Instruction set:** 64-bit

**Graphic Engine:** Intel® HD Graphics 400 (8th Gen, Supports DirectX11.2, OpenGL4.4 and OpenCL 2.0)

**Internal Memory:** 64GB

**USB:** 2 x USB 2.0

**LAN:** 10/100/1000M Ethernet

**Wi-Fi:** 802.11b/g/n

**OS:** Android /Windows

## AV Inputs:

**Video:** HDMI, VGA, BNC

**Control:** RS-232

**Audio:** Audio Socket (3.5mm)

**Speaker Type:** 2W, 5Ω (x2)

**Input Voltage:** AC110~240V (50Hz~60Hz)

## Media Player:

**Video:** MPG, AVI, MP4, RM, RMVB, TS

**Audio:** MP3, WMA

**Image:** JPG, GIF, BMP, PNG

## Touch:

**Touch Technology:** Projected Capacitive

**Touch Points:** 10

**Glass hardness:** 7H minimum

## Accessories:

**Included:** Remote Control, User Manual, Power Cable, USB to USB Cable, Wi-Fi Aerial

**Optional:** Special Wall Mount, Floor Stand/Trolley, Ceiling Mount, Table Stand